

## Instruction Manual

Product Number: FKB

Thank you for purchasing the THERMOS Vacuum Insulated Straw Tumbler.  
This page gives detailed handling instructions for the product.

For Household Use

### For Cold Retention Only

#### Before Use

- Check that all the parts are included.
- Thoroughly clean all parts.

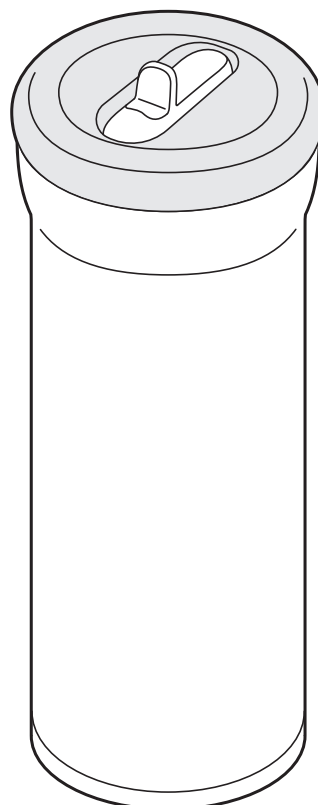

### Contents

#### Before Use

- P.1 Part Names
- P.2 Precautions
- P.5 Notes on Use

#### Usage Instructions

- P.6 How to Use
- P.8 Product Care

#### Troubleshooting

- P.11 In This Case
- P.12 How to Purchase Replacement Parts (Sold Separately)

# Part Names

Before use, check that all the parts are included.

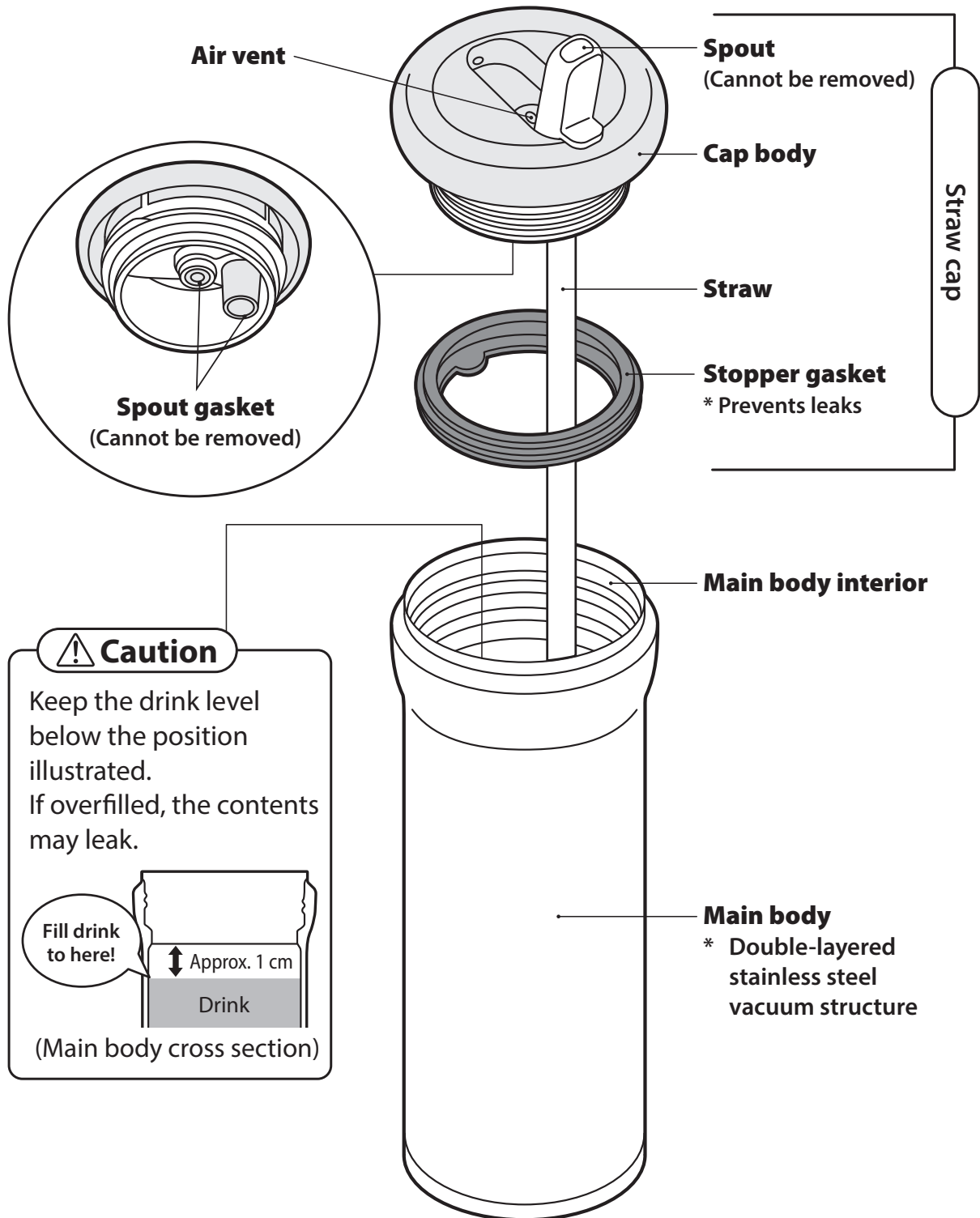

Properly attach the dedicated stopper gasket and straw to the straw cap before use.

\* Otherwise, the contents may leak.

# Precautions

Read these precautions carefully before use and be sure to follow them.

## Meaning of displayed markings

■ To ensure that this product is properly used, the extent of harm or damage caused by improper usage is categorized as follows.

 <b>Warning</b>	This mark indicates content that could result in death or serious injury.	 <b>Caution</b>	This mark indicates content that could result in minor injury or property damage.
--	---	--	---

■ Symbols

 <b>Prohibited</b>	This mark indicates actions to avoid.	 <b>Required</b>	This mark indicates actions that must be followed.
---	---------------------------------------	---	--

## Warning



**Keep this product out of reach of young children.  
Also, make sure it is not used as a toy.**

- \* Small parts are a choking hazard and are at risk of being swallowed.
- Also, such use may cause injury or stain your belongings.



**Do not pour a hot drink into this product.**

- \* Otherwise, hot liquid directly entering the mouth may result in burns.
- \* If the internal pressure rises, the straw cap may not open or may fly off, causing the contents to burst out and possibly resulting in burns, injury, or staining your belongings.



## Caution



**Do not use this product for purposes other than drink storage.**

- \* Doing so may cause injury.



**Do not tilt or turn the main body upside down while the spout is raised.**

- \* Otherwise, the drink may spill out from the spout or air vent, possibly staining your belongings.



**Do not tilt the main body too much or hold it sideways when drinking.**

- \* Otherwise, the drink may spill out from the spout or air vent, possibly staining your belongings.



**When you finish drinking, be sure to firmly push the spout closed.**  
( P.7 ⑤)

- \* Otherwise, the drink may spill out from the spout or air vent, possibly staining your belongings.



**Attach only the dedicated parts to this product.**

- \* Otherwise, the contents may leak, possibly staining your belongings.

# Precautions



Required

**Properly attach the dedicated stopper gasket and straw to the straw cap. (P.9)**

\* Otherwise, the contents may leak, possibly staining your belongings.



Prohibited

**Do not leave this product near a stove, gas heater, or other fire source.**

\* Doing so may cause burns. Additionally, the product may become deformed, possibly causing leaks that could stain your belongings.



Prohibited

**Do not carry the product while the spout is raised.**

\* If the main body is tilted or turned upside down, the drink may spill out from the spout or air vent, possibly staining your belongings.



Prohibited

**Do not tilt or shake the straw cap when closing the stopper. (P.6 3)**

\* Otherwise, the drink may overflow. Also, the contents may leak, possibly staining your belongings.

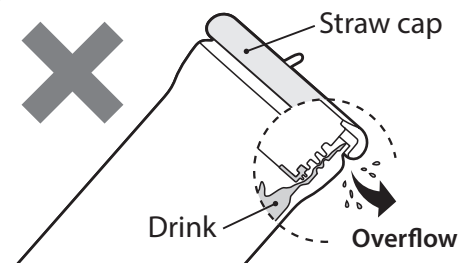

Required

**Avoid cramming large pieces of ice inside. Break them into smaller pieces.**

\* The maximum fill part on the inside of the main body may become deformed, possibly causing leaks that could stain your belongings.



Required

**Close the straw cap securely. (P.6 3)**

\* Otherwise, the contents may leak, possibly staining your belongings.



Required

**Keep the drink level below the prescribed position illustrated.**

\* Overfilling may cause the drink to overflow when closing the straw cap. Also, the contents may leak during use, possibly staining your belongings.

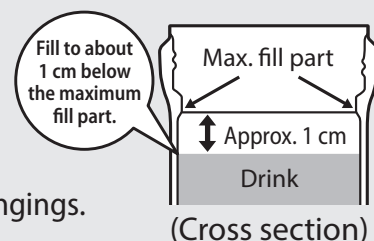

(Cross section)

**To care for the product, be sure to follow the instructions below.**



Prohibited

**Do not boil this product. (Except for the stopper gasket)**

\* Heat may cause the product to become deformed, possibly causing leaks that could stain your belongings.



Prohibited

**Do not use a dishwasher or dish dryer to wash the product. (Except for the stopper gasket)**

\* Heat may cause the product to become deformed, possibly causing leaks that could stain your belongings.

# Precautions

 **Avoid dropping the product, knocking it, or otherwise subjecting it to strong impact.**

Prohibited

\* Doing so may cause injury, or the contents may leak, possibly staining your belongings. It may also result in insufficient cold retention or a damaged straw cap.

 **Do not put this product in the microwave.**

Prohibited

\* The metal parts will spark, possibly resulting in damage to the microwave.  
\* Heat may cause the product to become deformed, possibly causing leaks that could stain your belongings.

 **Never modify, disassemble, or repair the product.**

Prohibited

\* Doing so may cause damage or result in an accident.

**Never put the following inside the container.**

 **Dry ice and carbonated drinks**

Prohibited

\* If the internal pressure rises, the straw cap may not open or may fly off, causing the contents to burst out and possibly resulting in injury or staining your belongings.

 **Perishable items such as milk, other dairy, and fruit juice**

Prohibited

\* Otherwise, the drink may spoil or go bad. Also, if a drink is left unattended for a long time, gases released through spoilage may increase the internal pressure until the straw cap cannot open or flies off, causing the contents to burst out and possibly resulting in injury or staining your belongings.

 **Tea leaves and pulp**

Prohibited

\* If the crevices become clogged, the contents may leak, possibly staining your belongings.

 **Do not leave a drink in this product for a long time.**

Prohibited

\* Otherwise, the drink may spoil or go bad. Also, if the internal pressure rises due to gases released through spoilage, the straw cap may not open or may fly off, causing the contents to burst out and possibly resulting in injury or staining your belongings.

 **Do not attach or remove the straw cap while the spout is raised.**

Prohibited

\* Deformation or damage may cause leaks, possibly staining your belongings.

 **Avoid using this product if you hear sloshing sounds coming from inside of the double-layered vacuum structure (vacuum layer).**

Prohibited

\* If liquid from the vacuum layer seeps into the main body, consuming it may cause health issues.

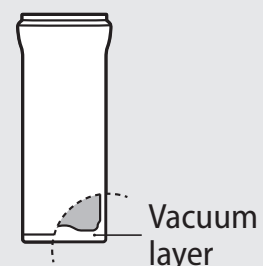

# Precautions

---

 **Do not leave your beverage for too long inside.**  
Required \* Otherwise, the drink may spoil or go bad.

 **When placing this product in a bag, make sure that the spout will not open due to other items inside the bag.**  
Required \* Otherwise, the contents may leak, possibly staining your belongings.

 **Be careful of tipping over the product when the main body contains a drink.**  
Required \* Otherwise, the drink may spill, possibly staining your belongings.

## Notes on Use

---

**Refrain from inserting soups and other high-salt content items into the container.**

\* The main body uses stainless steel for its interior lining. However, exposure to salt may potentially cause rusting and diminish its ability to keep beverages cold for an extended period.

**After use, immediately clean the product and thoroughly dry it. If you have gone out or otherwise cannot properly care for the product after use, quickly and thoroughly rinse the interior of the main body with water.**

\* Otherwise, the product may rust or lose its cold retention.

**Due to the product's structure, water droplets (condensation) may form on the straw cap when humidity is high. Please handle with care.**

**When placing the product in a bag, place it upright to prevent any potential leaks.**

**If the cold retention is reduced, stop using the product.**

**Before going out, turn the product upside down to check for leaks.**

\* If the product leaks, check the items listed in "In This Case" on P.11.

**Be aware that strong shaking or changes in the temperature and pressure inside the main body can cause the air inside to expand and increase pressure, which may cause the drink to spill out from the air vent or spout tip when opening the lid.**

**Do not put this product in the freezer.**

\* Doing so may result in damage or insufficient cold retention.

# How to Use

Thoroughly clean all parts before use.

## 1 Removing the straw cap

Twist the straw cap in the direction of the arrow to remove it.

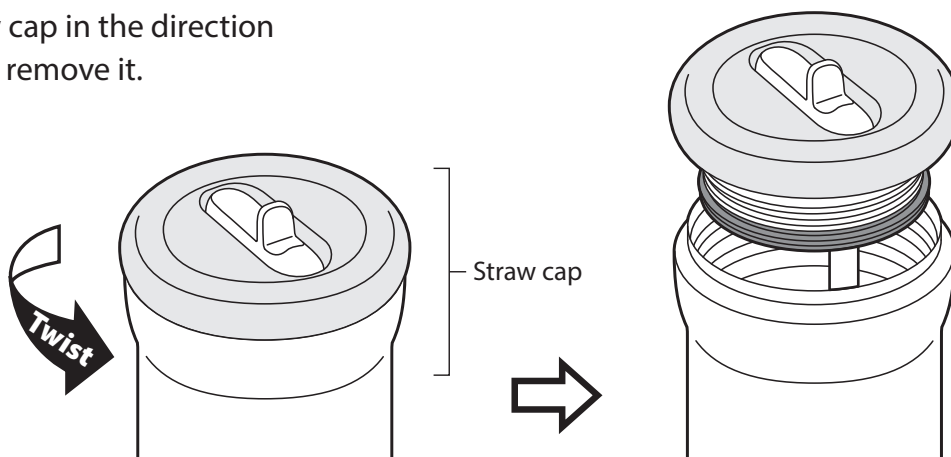

### Before use

- Thoroughly clean the straw cap and the inside of the main body. (👉 P.8)
- Confirm that the stopper gasket and straw are properly attached. (👉 P.9)

## 2 Pour in your drink

Keep the drink level below the prescribed position illustrated. Overfilling may cause the drink to overflow when closing the straw cap.



**Point** Before inserting the content, insert a small amount of cold water into the main body to precool the inside for about 1 minute. Doing so will increase its cold retention ability.

### Caution

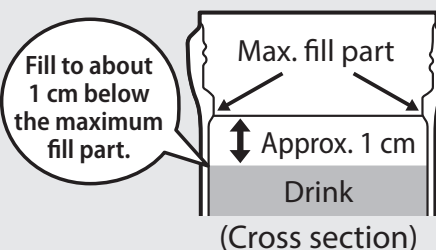

## 3 Closing the straw cap

With the spout pushed down, twist the straw cap in the direction of the arrow and close it securely.

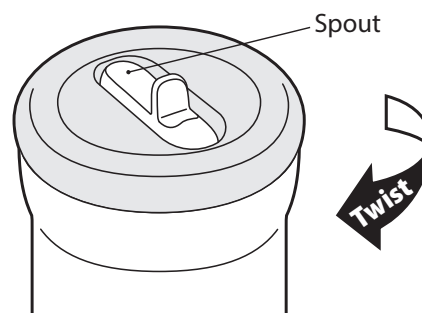

### Caution

**Do not tilt or shake the straw cap when closing the stopper.**

- \* Otherwise, the drink may overflow. Also, the contents may leak, possibly staining your belongings.

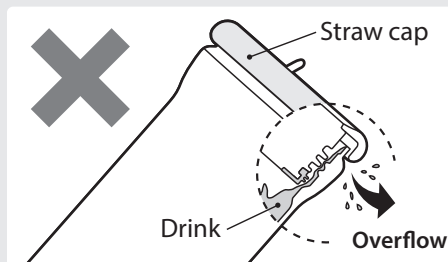

# How to Use

---

## 4 Drink your beverage

---

- ① Hook your finger on the tab and lift the straw cap unit until it becomes fixed.

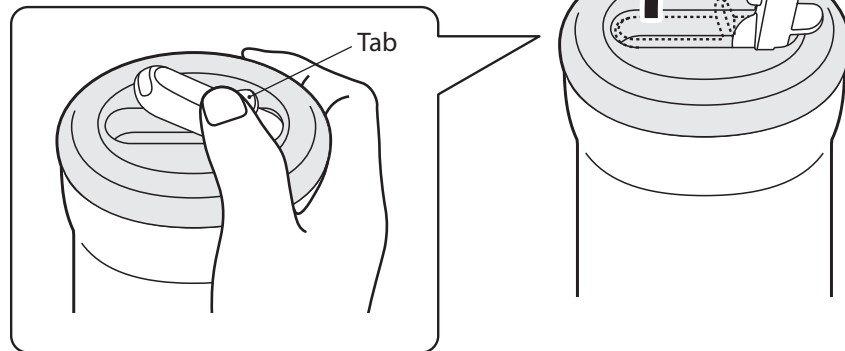

- ② Drink from the spout.

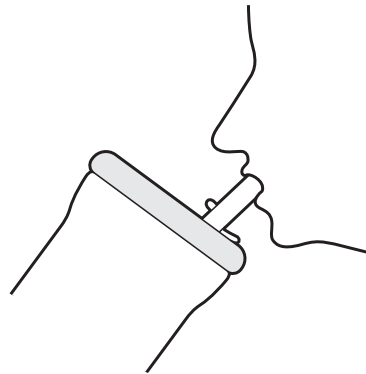

## 5 When finished drinking

---

Firmly push the spout in the direction of the arrow.

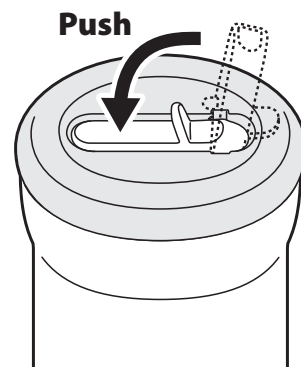



# Product Care

To prevent smells, stains, and mold and keep the product clean for a long time, always properly maintain it after use.

- After use, immediately clean the product and thoroughly dry it.
- Remove the stopper gasket and straw, and clean them thoroughly.
- If you will not be using the product for a long time, clean it thoroughly to remove any dirt, thoroughly dry it, and then store it in a place that is not too hot or humid.

Part name How to wash		Straw cap			Main body	
		Spout Cap body	Stopper gasket	Straw	Inside	Outside
Running water rinse		✓	✓	✓	✓	✓
Soak and wash		✗	✓	✓	✓	✗
Bleach	Oxygen-based	✗	✓	✓	✓	✗
	Chlorine-based	✗	✓	✓	✗	✗
Dishwasher* Dish dryer		✗	✓	✗	✗	✗
Heat resistance		—	140°C	—	—	—

\* Before using a dishwasher, dryer, and detergent, check the instruction manuals to confirm the conditions of washable parts (heat resistance, etc.) and the washing method.

## Precautions during Product Care

Before performing product care, read these precautions carefully and be sure to follow them.



**Do not boil this product.  
(Except for the stopper  
gasket)**

\* Heat may cause the product to become deformed, possibly causing leaks that could stain your belongings.



**Do not wash the outside of  
the main body, the spout, or  
the cap body by soaking.**

\* Doing so may cause discoloration or peeling of the paint and printing.  
\* Water may enter the gaps.



**Do not use chlorine bleach  
for the main body.**

\* Otherwise, the product may rust or lose its cold retention.



**Do not use a dishwasher or  
dish dryer to wash the  
product. (Except for the  
stopper gasket)**

\* Heat may cause the product to become deformed, possibly causing leaks that could stain your belongings.



**Do not use paint thinner,  
benzine, steel scrubbers,  
polishing powder, or cleansers  
to clean this product.**

\* Doing so may cause rust, scratches, or damage.



Required

**After use, rinse the inside of  
the spout with a strong  
stream of water and thor-  
oughly dry it.**

# Product Care

## How to attach the gasket and straw

■ How to remove the straw cap (P.6 ①)

### How to attach the gasket

Check which side is the top or bottom, and attach it properly to the cap body. After you attach it, press evenly around the stopper gasket with your fingers to ensure that no part is raised.

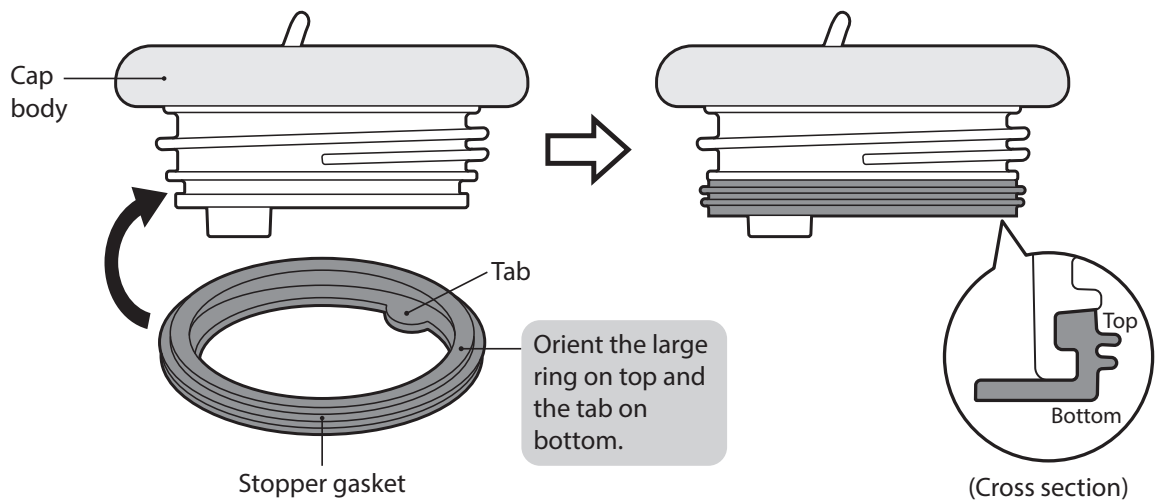

### How to attach the straw

Insert the straw fully to the base of the straw attachment.

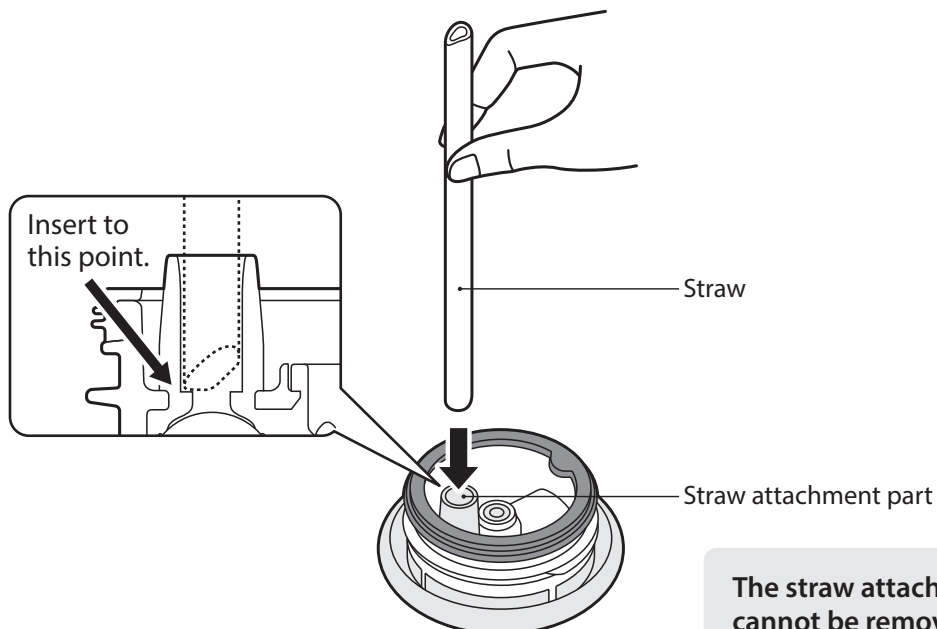

**The straw attachment part cannot be removed. Do not attempt to forcibly pull the straw attachment part.**

\* Doing so may result in damage.

# Product Care

## Normal product care

- Use neutral dish detergent that is diluted in lukewarm water, and after rinsing, drain out all of the water and thoroughly dry the parts.

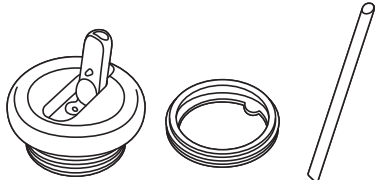
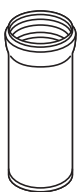
<p><b>Straw cap</b> Cap body, stopper gasket, spout, and straw</p> 	<p><b>Cap body and stopper gasket</b> Use a soft sponge.</p> <p><b>Straw</b> After cleaning with a dedicated straw brush, thoroughly rinse the inside with a strong stream of water.</p> <p><b>Spout</b> Rinse the inside of the spout with a strong stream of water.</p>
<p><b>Main body</b></p> 	<p>Use a soft sponge or bottle brush. Wipe the outside with a dry cloth immediately after washing. * Otherwise, water droplets may leave marks or cause rust.</p>

## Thorough product care

- Use kitchen bleach in accordance with its warning label, and after rinsing, drain out all of the water and thoroughly dry the parts.

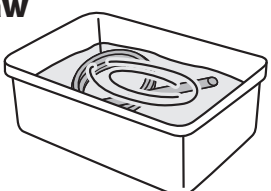
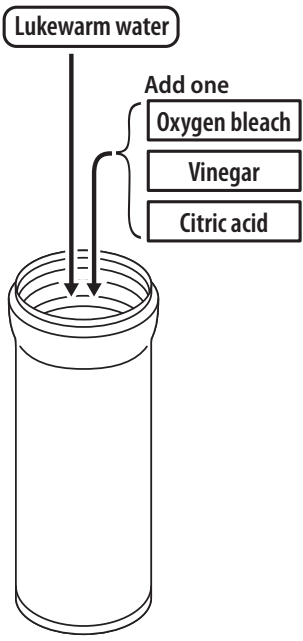
<p><b>Stopper gasket and straw</b></p> 	<p><b>For tea stains, etc.</b> Mix bleach and water in a bowl or other container, and soak each of the parts. (Approx. 30 min.)</p> <p><b>Prohibited</b> Do not wash the spout or the cap body by soaking. * Water may enter the gaps.</p>
<p><b>Main body interior</b></p> 	<p><b>For tea stains, etc.</b> Use oxygen bleach only on the inside. (Approx. 30 min.)</p> <p><b>Prohibited: Chlorine bleach</b> Do not attach the straw cap. * Doing so is dangerous, as pressure will rise inside the main body, and the straw cap may suddenly fly off.</p> <p><b>Specks of red rust</b> This is caused by a buildup of iron and other impurities in the water. Pour a mixture of 90% lukewarm water and 10% vinegar into the main body, and then wait about 30 minutes before rinsing it well.</p> <p><b>Gritty residue</b> This is caused by a buildup of calcium and other impurities in the water. Pour a mixture of lukewarm water and 1% to 2% citric acid into the main body, and then leave it for about 3 hours without attaching the straw cap before rinsing it well.</p>

## In This Case

If an uncertain situation arises, check the items below.

Issue	Cause	Solution
<b>The straw cap is leaking.</b>	The straw cap or spout is not securely closed.	Close the straw cap and spout securely. (👉 P.6 ③, P.7 ⑤)
	Too much drink is inside.	Keep the drink level below the prescribed amount. (👉 P.6 ②)
	The stopper gasket has slipped, or it is not attached securely.	Securely attach the stopper gasket in the proper position. (👉 P.9)
	The straw cap or stopper gasket is damaged or worn.	Purchase replacement parts, which are sold separately. (👉 P.12)
	Some drink remains inside the spout.	Make sure no drink remains inside the spout before closing it. (👉 P.7 ⑤)
<b>I cannot drink the beverage.</b>	The straw is detached.	Be sure to attach the straw and push it in firmly. (👉 P.9)
<b>The inside of the main body is discolored.</b>	The interior is stained.	Use oxygen bleach to clean the interior. (👉 P.10)
	Specks of rust are attached to the interior.	This is caused by a buildup of iron and other impurities in the water. Use vinegar to clean the interior. (👉 P.10)
	Gritty residue is attached to the interior.	This is caused by a buildup of calcium and other impurities in the water. Use citric acid to clean the interior. (👉 P.10)
<b>The cold retention is ineffective.</b>	The drink put inside was not cold enough.	Pour a cold drink into this product. Precooling the inside of the main body before use is also effective.
	There is not enough drink.	Increase the amount of ice or drink.
<b>The product smells bad.</b>	The inside of the main body is dirty.	Clean the product and thoroughly dry it. If this does not remove the smell, use oxygen bleach. (👉 P.10)
<b>The straw or stopper gasket is discolored.</b>	The straw or gasket is stained or moldy.	Use bleach to clean the gasket. (👉 P.10) If the dirt or mold cannot be removed, dispose of the gasket and purchase a replacement, which is sold separately. (👉 P.12)
<b>When I shake the product, I hear a faint ringing.</b>		Metal inside the main body, which raises the effectiveness of cold retention, is brushing the sides and making noise. This is not a defect.

## How to Purchase Replacement Parts (Sold Separately)

Confirm the product number and color name, and then make a purchase using the method specified below.

(The product number and color name are indicated on the bottom of the main body.)

### ① THERMOS online shop (replacement part sales)

[https://www.shopthermos.jp/shop/goods/p\\_search.aspx](https://www.shopthermos.jp/shop/goods/p_search.aspx)

Order parts from the URL above. (Please be aware that the available parts are limited.)

**Web address: <https://www.thermos.jp/>**

To improve the product, some of its specifications may be changed without prior notice. Therefore, please be aware that the illustrations in this guide may differ slightly from the actual product.