

Instruction Manual

Product Number: JPB

Thank you for purchasing the THERMOS Vacuum Insulated Portable Mug.

This page gives detailed handling instructions for the product.

For Household Use

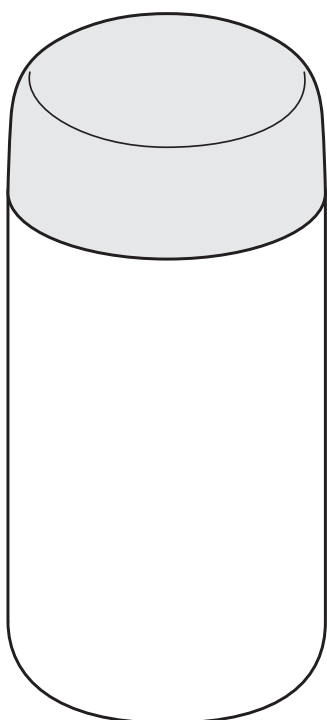

Before Use

- Check that all the parts are included.
- Thoroughly clean all parts.

If you overfill the liquid,
the contents may leak.

Fill drink to
here!

↑↓ Approx. 1 cm

Drink

(Main body cross section)

Contents

Before Use

- P.1 Part Names
- P.2 Precautions
- P.4 Notes on Use

Usage Instructions

- P.5 How to Use
- P.7 Product Care

Troubleshooting

- P.10 In This Case
- P.11 How to Purchase Replacement
Parts (Sold Separately)

Part Names

Before use, check that all the parts are included.

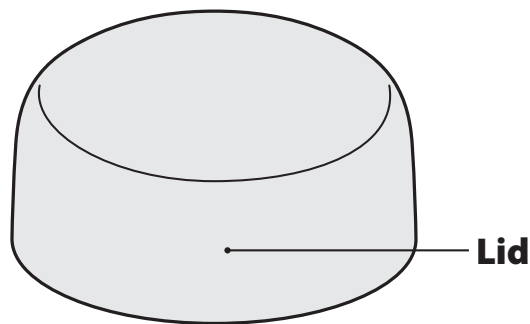

Lid

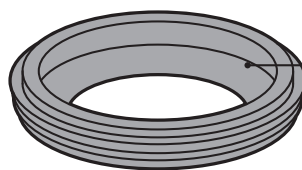

Gasket

* Prevents leaks

Caution

Keep the drink level below the position illustrated. If overfilled, the contents may leak.

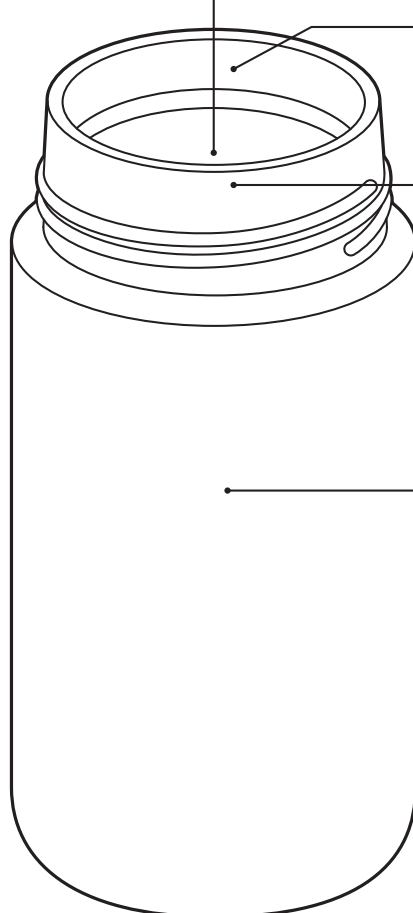
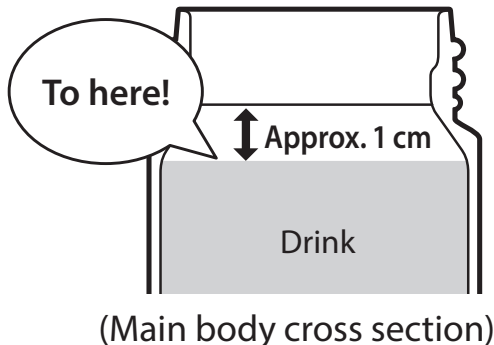

Main body interior
(Ceramic coating treatment)

Spout

Main body
* Double-layered stainless steel vacuum structure

Properly attach the dedicated gasket before use.

* Otherwise, the contents may leak.

Precautions

Read these precautions carefully before use and be sure to follow them.

Meaning of displayed markings

■ To ensure that this product is properly used, the extent of harm or damage caused by improper usage is categorized as follows.

 Warning	This mark indicates content that could result in death or serious injury.	 Caution	This mark indicates content that could result in minor injury or property damage.
--	---	--	---

■ Symbols

 Prohibited	This mark indicates actions to avoid.	 Required	This mark indicates actions that must be followed.
---	---------------------------------------	---	--

Warning



**Keep this product out of reach of young children.
Also, make sure it is not used as a toy.**

- * Small parts are a choking hazard and are at risk of being swallowed. Also, this behavior may result in burns or injury.

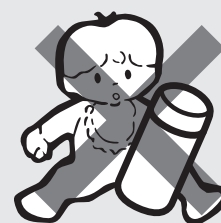

Caution



Do not use this product for purposes other than drink storage.

- * Doing so may cause injury.



Properly attach the dedicated gasket to the lid. (P.8)

- * Otherwise, the contents may leak, possibly resulting in burns or staining your belongings.



When drinking a hot beverage, drink slowly and do not tilt the main body quickly.

- * Otherwise, the rush of hot liquid may result in burns and other issues.



Do not tilt or shake the main body when closing the lid. (P.5 ③)

- * Otherwise, the drink may overflow. Also, the contents may leak, possibly resulting in burns or staining your belongings.



Do not leave this product near a stove, gas heater, or other fire source.

- * Doing so may cause burns. Additionally, the product may become deformed, possibly causing leaks that could result in burns or staining your belongings.

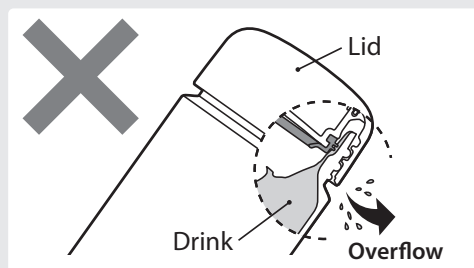

Close the lid securely. (P.5 ③, P.6 ⑤)

- * Otherwise, the contents may leak, possibly resulting in burns or staining your belongings.



Attach only the dedicated parts to this product.

- * Otherwise, the contents may leak, possibly resulting in burns or staining your belongings.

Precautions



Avoid cramming large pieces of ice inside. Break them into smaller pieces.

- * The maximum fill part on the inside of the main body may become deformed possibly causing leaks that could result in burns or staining your belongings.



Keep the drink level below the prescribed position illustrated.

- * Overfilling may cause the drink to overflow when closing the lid. Also, the contents may leak during use, possibly resulting in burns or staining your belongings.

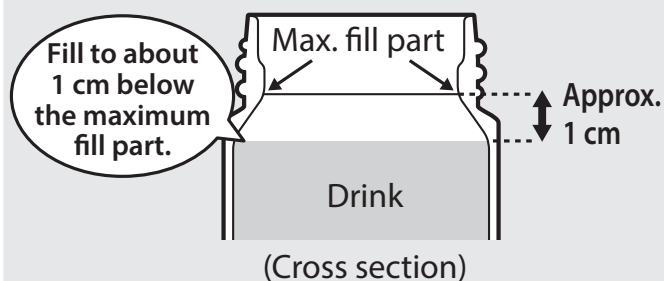

Never put the following inside the container.



Dry ice and carbonated drinks

- * If the internal pressure rises, the lid may not open or may fly off, causing the contents to burst out and possibly resulting in injury or staining your belongings.



Tea leaves and pulp

- * If the crevices become clogged, the contents may leak, possibly resulting in burns or staining your belongings.



Do not leave a drink in this product for a long time.

- * Otherwise, the drink may spoil or go bad. Also, if the internal pressure rises due to gases released through spoilage, the lid may not open or may fly off, causing the contents to burst out and possibly resulting in injury or staining your belongings.



Do not leave your beverage for too long inside.

- * Otherwise, the drink may spoil or go bad.

To care for the product, be sure to follow the instructions below.



After use, immediately clean the product and thoroughly dry it.

- * Residue left after washing may grow bacteria and contaminate your drinks.



Do not boil this product.

- * Heat may cause the product to become deformed, possibly causing leaks that could result in burns or staining your belongings.



Be careful of tipping over the product when the main body contains a drink.

- * Otherwise, the drink may spill, possibly resulting in burns or staining your belongings.



Avoid dropping the product, knocking it, or otherwise subjecting it to strong impact.

- * Doing so may cause injury, or the contents may leak, possibly resulting in burns or staining your belongings. It may also result in insufficient heat and cold retention or a damaged lid.



Never modify, disassemble, or repair the product.

- * Doing so may cause damage or result in an accident.



Do not put this product in the microwave.

- * The metal parts will spark, possibly resulting in damage to the microwave.
- * Heat may cause the product to become deformed, possibly causing leaks that could result in burns or staining your belongings.



If the heat or cold retention is reduced, stop using the product.

- * Storing a hot drink will heat up the main body, possibly resulting in burns.

Precautions



Prohibited

Avoid using this product if you hear sloshing sounds coming from inside of the double-layered vacuum structure (vacuum layer).

* If liquid from the vacuum layer seeps into the main body, consuming it may cause health issues.

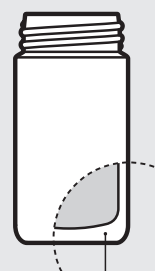

Vacuum layer

Notes on Use

Refrain from inserting soups and other high-salt content items, as well as warm sports drinks, into the container.

* The main body uses stainless steel for its interior lining. However, exposure to salt may potentially cause rusting and diminish its ability to keep beverages hot or cold for an extended period.

After use, immediately clean the product and thoroughly dry it.

If you have gone out or otherwise cannot properly care for the product after use, quickly and thoroughly rinse the interior of the main body with water.

* Otherwise, the product may rust or lose its heat and cold retention.

Before going out, turn the product upside down to check for leaks.

* If the product leaks, check the items listed in "In This Case" on P.10.

When placing the product in a bag, place it upright to prevent any potential leaks.

Do not put this product in the freezer.

* Doing so may result in damage or insufficient heat and cold retention.

Do not use a metal stirring stick or spoon.

* Otherwise, the product may become scratched, or the coating may peel off.

Do not damage the coating inside the main body, and stop using the product if the coating has peeled off.

* Otherwise, the product may rust or lose its heat and cold retention.

The ceramic coating is compliant with the Food Sanitation Act, so rest assured that even if it peels away and is consumed during use, it will be naturally expelled.

How to Use

1 Remove the lid

Twist the lid in the direction of the arrow to remove it.

Before use

- Thoroughly clean the lid and main body. (☞ P.7)
- Confirm that the gasket is properly attached. (☞ P.8)

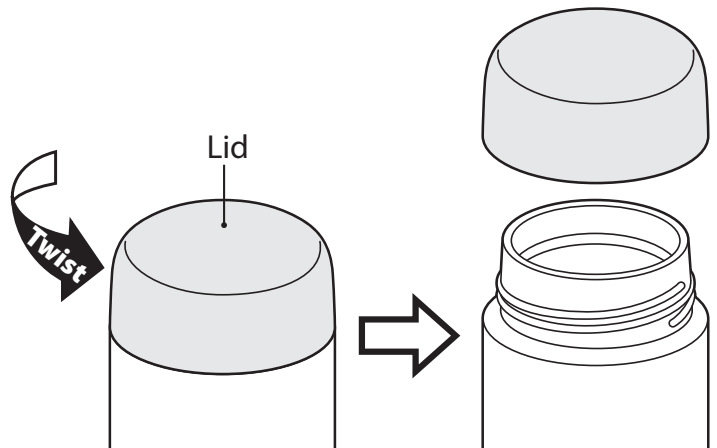

2 Pour in your drink

Keep the drink level below the prescribed position illustrated. Overfilling may cause the drink to overflow when closing the lid.

Point



Before inserting the content, insert a small amount of hot water (or cold water) into the main body to preheat (or precool) the inside for about 1 minute. Doing so will increase its heat (or cold) retention ability.

Caution

Fill to about 1 cm below the maximum fill part.

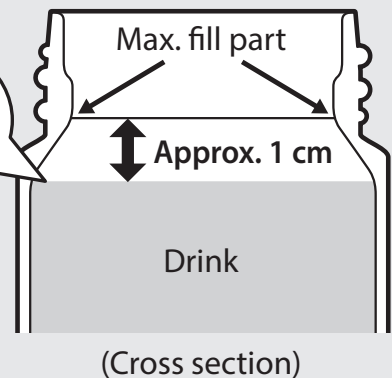

3 Close the lid

With the main body upright, twist the lid in the direction of the arrow to close it securely.

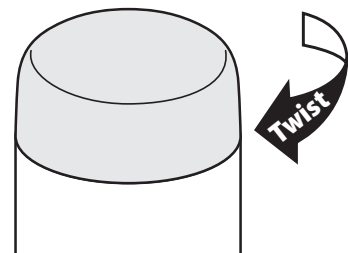

Caution

Do not tilt or shake the main body when closing the lid.

- * If the drink overflows, it may spill, possibly resulting in burns or staining your belongings.

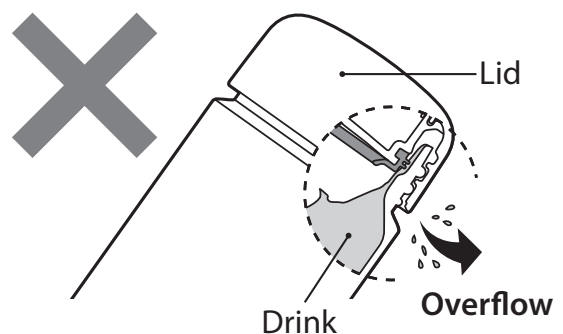

How to Use

4 Drink your beverage

- ① With the main body upright, twist the lid in the direction of the arrow to open it.

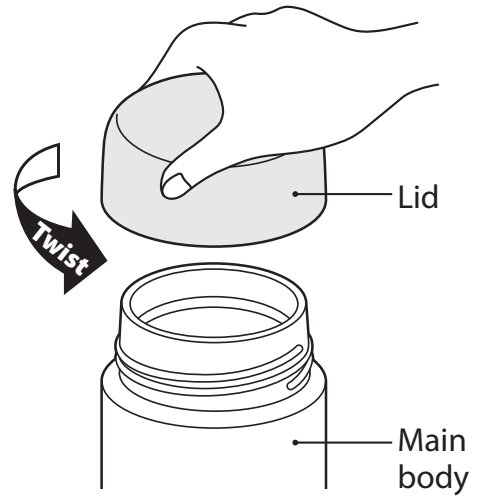

- ② Bring the spout to your mouth, and drink while tilting slowly.
(When the product contains a hot drink, be careful of burns.)

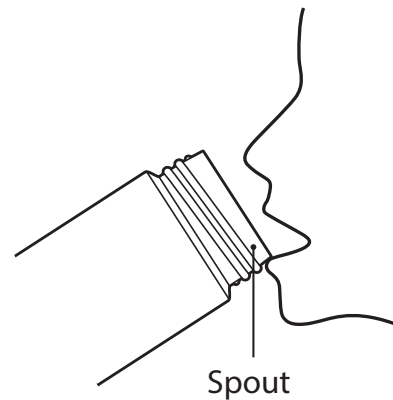

5 When finished drinking

With the main body upright, twist the lid in the direction of the arrow until it stops to close it securely.

Caution

Do not leave the lid open.

- * If the product tips over, the drink may spill, possibly resulting in burns or staining your belongings.

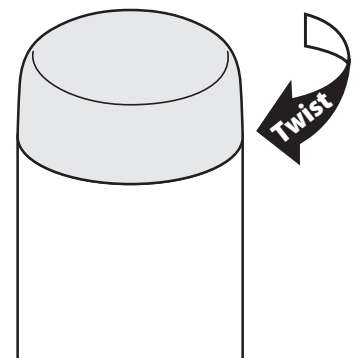

Product Care

To prevent smells, stains, and mold and keep the product clean for a long time, always properly maintain it after use.

- After use, immediately clean the product and thoroughly dry it.
- Remove the gasket and clean it thoroughly.
- If you will not be using the product for a long time, clean it thoroughly to remove any dirt, thoroughly dry it, and then store it in a place that is not too hot or humid.

Part name How to wash		Lid	Gasket	Main body	
				Inside	Outside
Running water rinse		✓	✓	✓	✓
Soak and wash		✓	✓	✓	×
Bleach	Oxygen-based	✓	✓	✓	×
	Chlorine-based	✓	✓	×	×
Dishwasher* Dish dryer		✓	✓	✓	✓
Heat resistance		100°C	140°C	—	—

* Before using a dishwasher, dryer, and detergent, check the instruction manuals to confirm the conditions of washable parts (heat resistance, etc.) and the washing method.

Precautions during Product Care

Before performing product care, read these precautions carefully and be sure to follow them.



Do not boil this product.

Prohibited

* Heat may cause the product to become deformed, possibly causing leaks that could result in burns or staining your belongings.



If using a dishwasher, do not place the main body on the dish rack where the metal is exposed.

Prohibited

* Otherwise, the paint may peel off.



Do not wash the outside of the main body by soaking.

Prohibited

* Doing so may cause discoloration or peeling of the paint and printing.



Do not use paint thinner, benzine, steel scrubbers, polishing powder, or cleansers to clean this product.

Prohibited

* Doing so may cause rust, scratches, or damage.



Do not use chlorine bleach to clean the main body.

Prohibited

* Otherwise, the product may rust or lose its heat and cold retention.

Product Care

How to attach the gasket

■ How to remove the lid (👉 P.5 ①)

Check which side is the top or bottom, and attach the gasket properly to the lid. After you attach it, press evenly around the gasket with your fingers to ensure that no part is raised.

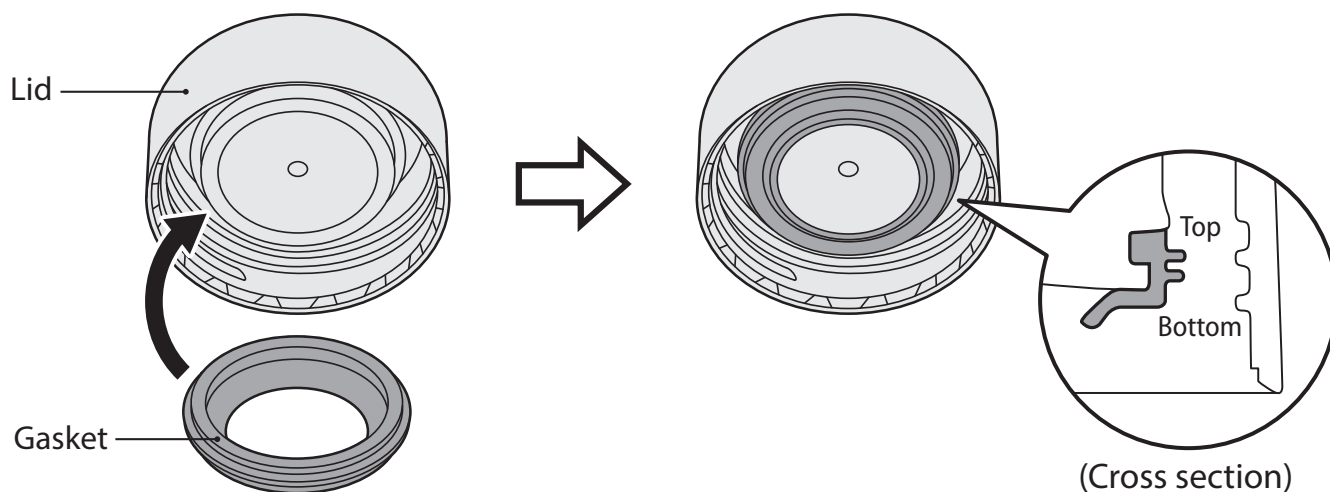

Product Care

Normal product care

- Use neutral dish detergent that is diluted in lukewarm water, and after rinsing, drain out all of the water and thoroughly dry the parts.

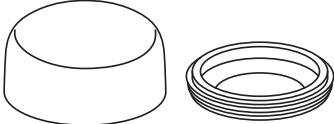
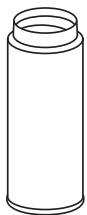
Lid Gasket 	Use a soft sponge. * After product care, be sure that the gasket is attached in the proper place. (P.8)
Main body 	Use a soft sponge or bottle brush. Wipe the outside with a dry cloth immediately after washing. * Otherwise, water droplets may leave marks or cause rust.

Thorough product care

- Use kitchen bleach in accordance with its warning label, and after rinsing, drain out all of the water and thoroughly dry the parts.

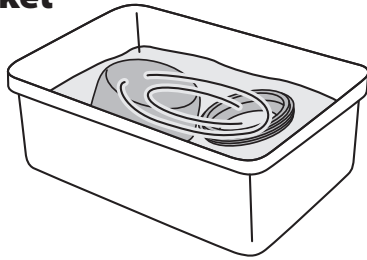
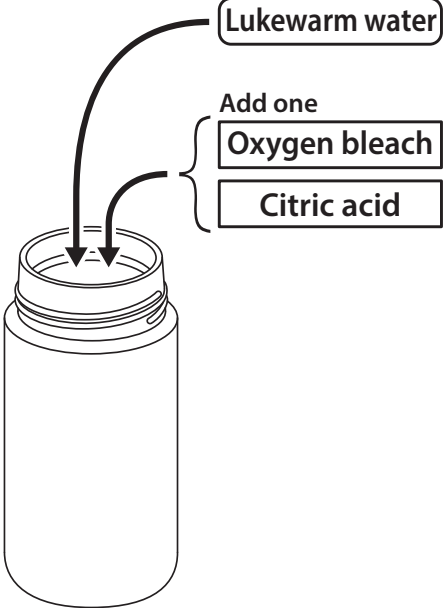
Lid Gasket 	For tea stains, etc. Mix bleach and water in a bowl or other container, and soak each of the parts. (Approx. 30 min.)
Main body interior 	For tea stains, etc. Use oxygen bleach only on the inside. (Soak for around 30 minutes, and do not leave it for an extended period.) ⊘ Prohibited: Chlorine bleach Do not attach the lid. * Doing so is dangerous, as pressure will rise inside the main body, and the lid may suddenly fly off. Gritty residue This is caused by a buildup of calcium and other impurities in the water. Pour a mixture of lukewarm water and 1% to 2% citric acid into the main body, and then leave it for about 3 hours without attaching the lid before rinsing it well.

In This Case

If an uncertain situation arises, check the items below.

Issue	Cause	Solution
The lid is leaking.	The lid is not securely closed, or it is loose.	When closing the lid, hold the main body upright, and do not tilt or shake the main body while closing it. (👉 P.5 ③)
	Too much drink is inside.	Keep the drink level below the prescribed amount. (👉 P.5 ②)
	The gasket has slipped, or it is not attached securely.	Securely attach the gasket in the proper position. (👉 P.8)
	The lid or gasket is damaged or worn.	Purchase replacement parts, which are sold separately. (👉 P.11)
The inside of the main body is discolored.	The interior is stained.	Use oxygen bleach to clean the interior. (👉 P.9)
	Gritty residue is attached to the interior.	This is caused by a buildup of calcium and other impurities in the water. Use citric acid to clean the interior. (👉 P.9)
Part of the outside of the main body has discolored to a whitish color.	Dishwasher detergent or limescale has attached to the product.	Run boiling water over the discolored area, and immediately wipe the outside with a dry cloth. If you leave the product wet, the water droplets may leave marks. The main body will become hot, so be careful of burns.
The heat retention (or cold retention) is ineffective.	The drink put inside was not hot (or cold) enough.	Pour a hot (or cold) drink into this product. Preheating (or precooling) the inside of the main body before use is also effective.
	There is not enough drink.	Increase the amount of drink.
The product smells bad.	The inside of the main body or the lid is dirty.	Clean the product and thoroughly dry it. If this does not remove the smell, follow the product care instructions and use oxygen bleach. (👉 P.9)
The gasket is discolored.	The gasket is stained or moldy.	Use bleach to clean the gasket. (👉 P.9)
		If the dirt or mold cannot be removed, dispose of the gasket and purchase a replacement, which is sold separately. (👉 P.11)
Green tea changes color to a reddish brown.		Do not leave your green tea for too long inside. When tea is kept hot, its components are altered, and the color and flavor change, but this is not harmful to humans.
When I shake the product, I hear a faint ringing.		Metal inside the double-layered vacuum structure (vacuum layer), which raises the effectiveness of heat retention (and cold retention), is brushing the sides and making noise. This is not a defect.

How to Purchase Replacement Parts (Sold Separately)

Confirm the product number and color name, and then make a purchase using the method specified below.

(The product number and color name are indicated on the bottom of the main body.)

① THERMOS online shop (replacement part sales)

https://www.shopthermos.jp/shop/goods/p_search.aspx

Order parts from the URL above. (Please be aware that the available parts are limited.)

Web address: <https://www.thermos.jp/>

To improve the product, some of its specifications may be changed without prior notice. Therefore, please be aware that the illustrations in this guide may differ slightly from the actual product.